

16.Trunk Lid Latch and Actuator Assembly

A: REMOVAL

1) Disconnect the ground cable from battery. <Ref. to NT-5, BATTERY, NOTE, Note.>

NOTE:

For the 12 volt engine restart battery of HEV model, disconnect the ground terminal from 12V engine restart battery sensor.

2) Remove the lock assembly - trunk lid.

(1) Disconnect the connector.

(2) Release the claws, and open the lock cover.

(3) Remove the bolts, and disconnect the release cable, and then remove the lock assembly - trunk lid.

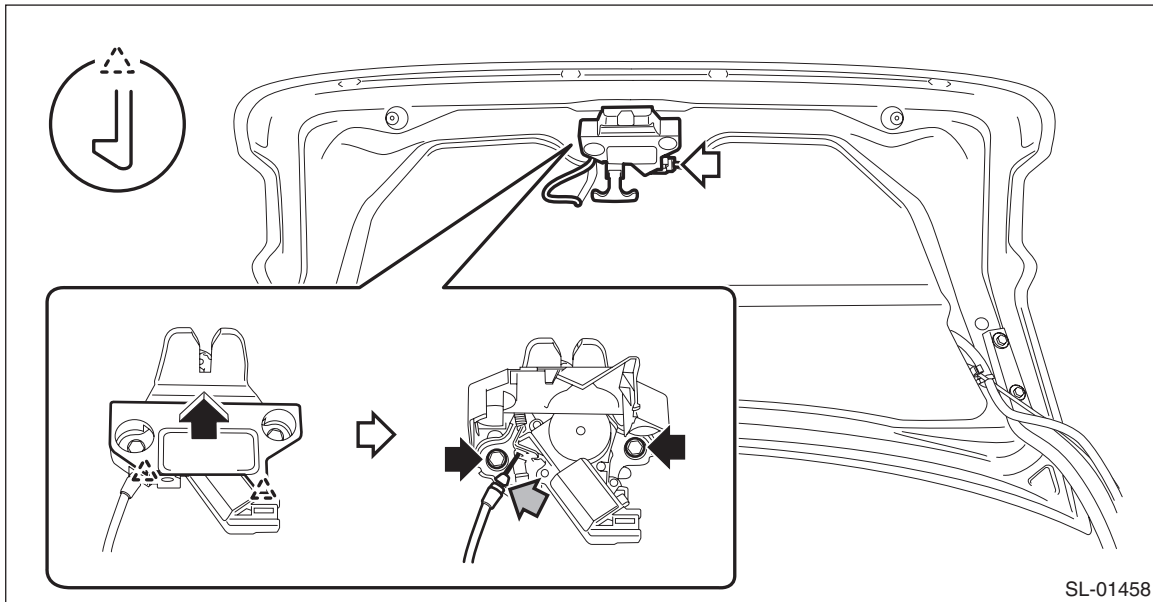

NOTE:

When disconnecting the release cable, refer to “TRUNK LID OPENER” of “Remote Openers”. <Ref. to SL-64, TRUNK LID OPENER, REMOVAL, Remote Openers.>

B: INSTALLATION

1) Before installation, check the following items.

- Is the cable deformed?
- Grease is applied sufficiently to cable joints.

If grease is insufficient, add it as necessary before assembling the cable.

2) Install each part in the reverse order of removal.

Tightening torque:

Refer to “COMPONENT” of “General Description”. <Ref. to SL-3, REAR GATE LOCK AND TRUNK LID LOCK, COMPONENT, General Description.>

C: INSPECTION

1. LATCH

Check if the latch operates normally.

If latch deformation, abnormal wear, or unsmooth lock operation is observed, replace the lock assembly - trunk lid.

2. ACTUATOR

UNIT INSPECTION

PREPARATION TOOL:

Circuit tester

1) Check door lock operation

Check the door lock operation when battery voltage is applied between the terminals of actuator.

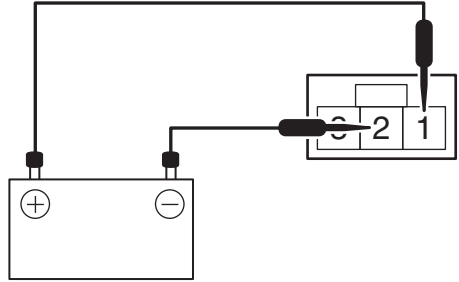
Terminal No.	Inspection conditions	Specification	Connection diagram
1 (+) — 2 (–)	Connect battery to the terminals	LOCK → UNLOCK	 <p>SL-01517</p>

2) CHECK SWITCH.

Check the resistance between actuator terminals.

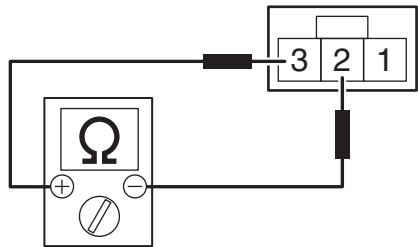
Terminal No.	Inspection conditions	Specification	Connection diagram
2 — 3	LOCK	1 MΩ or more	 <p>SL-01518</p>
	UNLOCK	Less than 1 Ω	

3) If it does not operate normally, replace the lock assembly - trunk lid.